

QUIK-SHIELD

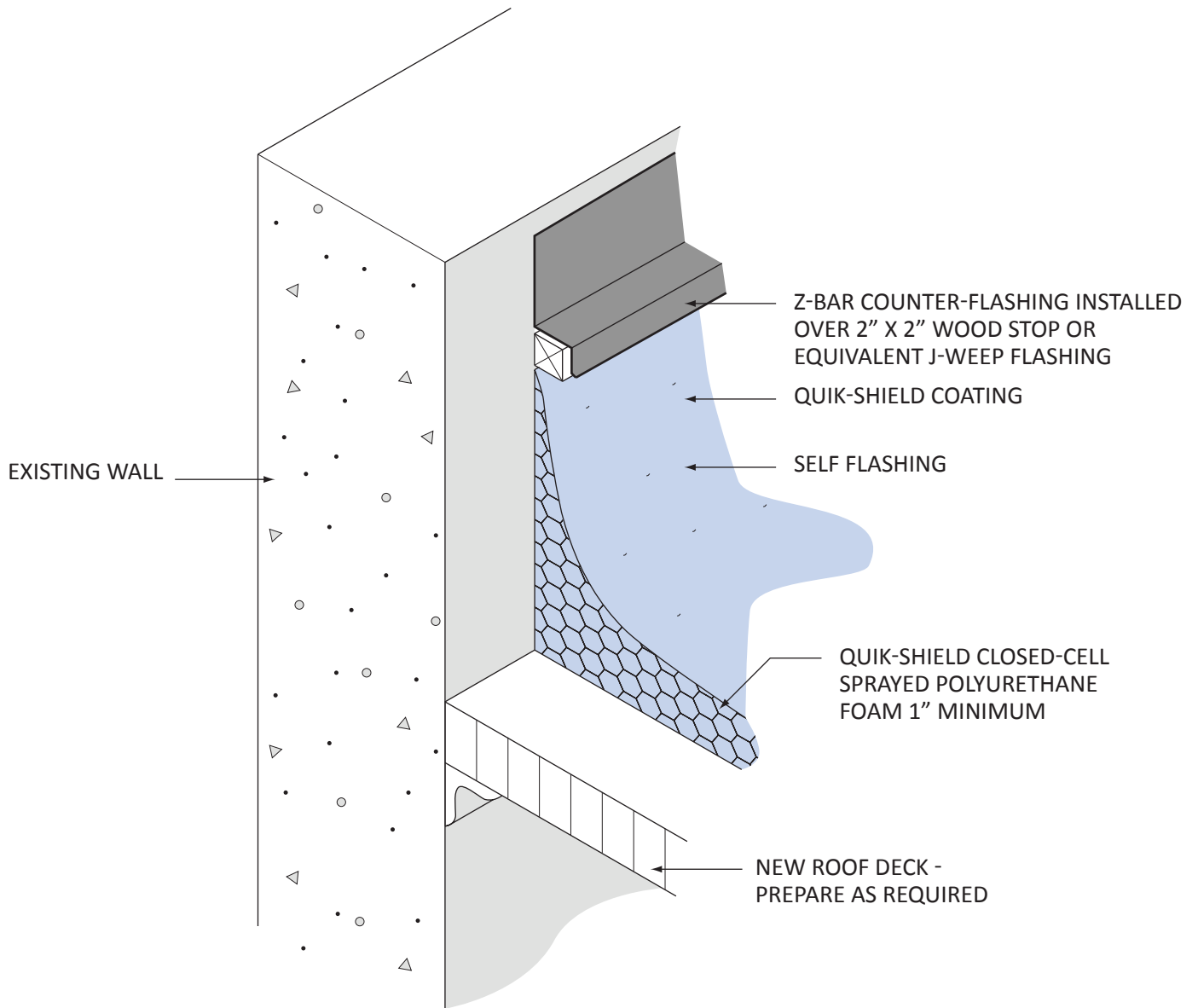

NOTE:

- 1- WOOD STOP BY FRAMES
- 2- THIS DETAIL TO BE USED ONLY WHEN THE DECK IS SUPPORTED BY THE WALL

**NEW FLASHING FOR CONCRETE
WALL-SUPPORTED DECK**
QSR-163 07-2012



SWD Urethane
Mesa, Arizona
800-828-1394
swdurethane.com